

# Timber Framed Substrate

## Opening Return - Jamb (Option 1)

- ~~~~~ = Indicates the primary weather line, designed and supplied by others
- \* = project specific, designed by others
- \*\* = project specific, supplied by others
- \*\*\* = project specific, designed and supplied by others

The SureBrick system is designed to transfer all of its dead loads (self weight), live loads and wind loadings back to the main substructure.

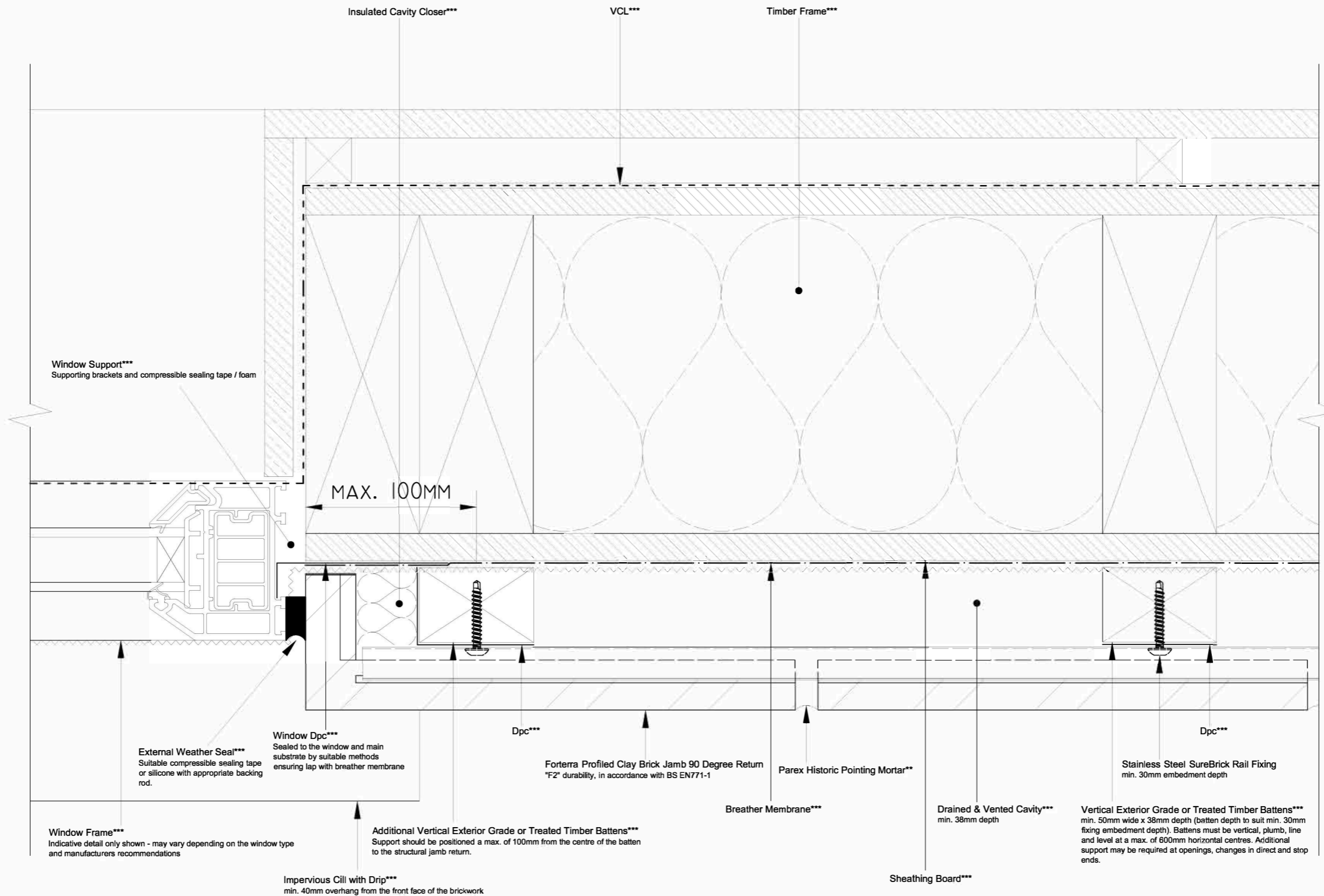

For further information, please contact our dedicated team: Atherstone Road, Measham Swadlincote, Derbyshire DE12 7EL

Tel. +44 (0) 330 123 1018

Email. [asktechnical@forterra.co.uk](mailto:asktechnical@forterra.co.uk)  
Web. [www.forterra.co.uk](http://www.forterra.co.uk)

Date. 17/04/2019

Revision. Drawing ref. **03-015**